

The JOY OF
LIVING

DEVELOPER

ADONIS
Adonis Projects Pvt. Ltd.

PARAMINE
REALTORS PVT. LTD.

MEMBER
CREDAI
BENGAL

In
Association with



ARCHITECT



SOLICITOR

PRABHAT KUMAR MAJI
Advocate & Tax Consultant

BRAND
CONSULTANT



Registered Office:

8/35, Fern Road, Kolkata - 700019

Communicating Address:

211, Shanti Pally, Block BF - 42, Kolkata - 700107,

shrivridhiconstruction@gmail.com,

www.adonisprojects.in / www.paraminerealtors.com

Site Address:

977, Motilal Gupta Road, Behala, Kolkata - 700008

For Details Call:

+91 83358 40404

श्रीniketan

M.G. Road -BEHALA

DISCLAIMER:

This document is not a legal offering. It only describes the content & concept of **SHRINIKETAN**. All the areas / dimensions / layout / elevations / pictures etc. are only indicative and not as per scale. All the details are subject to change, alteration & modification as per the developer's discretion.

ASPIRATION | IMAGINATION | PERFECTION

The Joy of LIFE



977
MOTILAL GUPTA ROAD

Shriniketan is an exclusive project in **Behala**, developed by **SHRIVRIDHI CONSTRUCTION**.

With its excellent planning & construction, pollution-free environment, and state-of-the-art amenities, Shriniketan offers its residents the opportunity to live the life of their dreams.

GROUND FLOOR PLAN

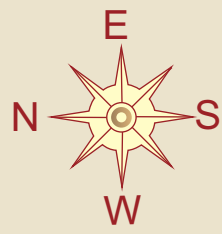

LOCATION MAP

WHEN CONVENIENCE IS MINUTES AWAY

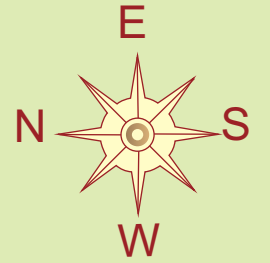

Excellent Connectivity

Excellent transport connectivity with major schools, medical facilities, daily markets, banks & restaurants. Multiple access to Behala & Tollygunge

- Diamond Harbour Road (NH 12) - 1.3 Kms
- Majerhat Railway Station - 5.2 Kms

Metro Stations

- Behala Chowrasta Metro Station - 2.0 Kms
- Tollygunj Metro Station - 3.0 Kms

Schools

- National Gems H.S. School – 2.5 Kms
- Bidya Bharati School – 2 Kms
- M.P. Birla Foundation H.S. School - 2 Kms

Hospitals

- Netradeep Eye Hospital - 1.5 Kms
- Narayan Memorial Hospital – 3.0 Kms
- Vidyasagar State General Hospital - 2.0 Kms

Banks

- Punjab National Bank - 400 Metre
- Bandhan Bank - 120 Metre
- State Bank of India - 1.4 Kms

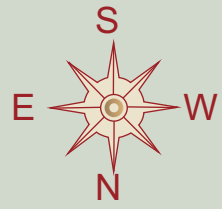

TYPICAL FLOOR PLAN FOR
1ST TO 4TH FLOOR

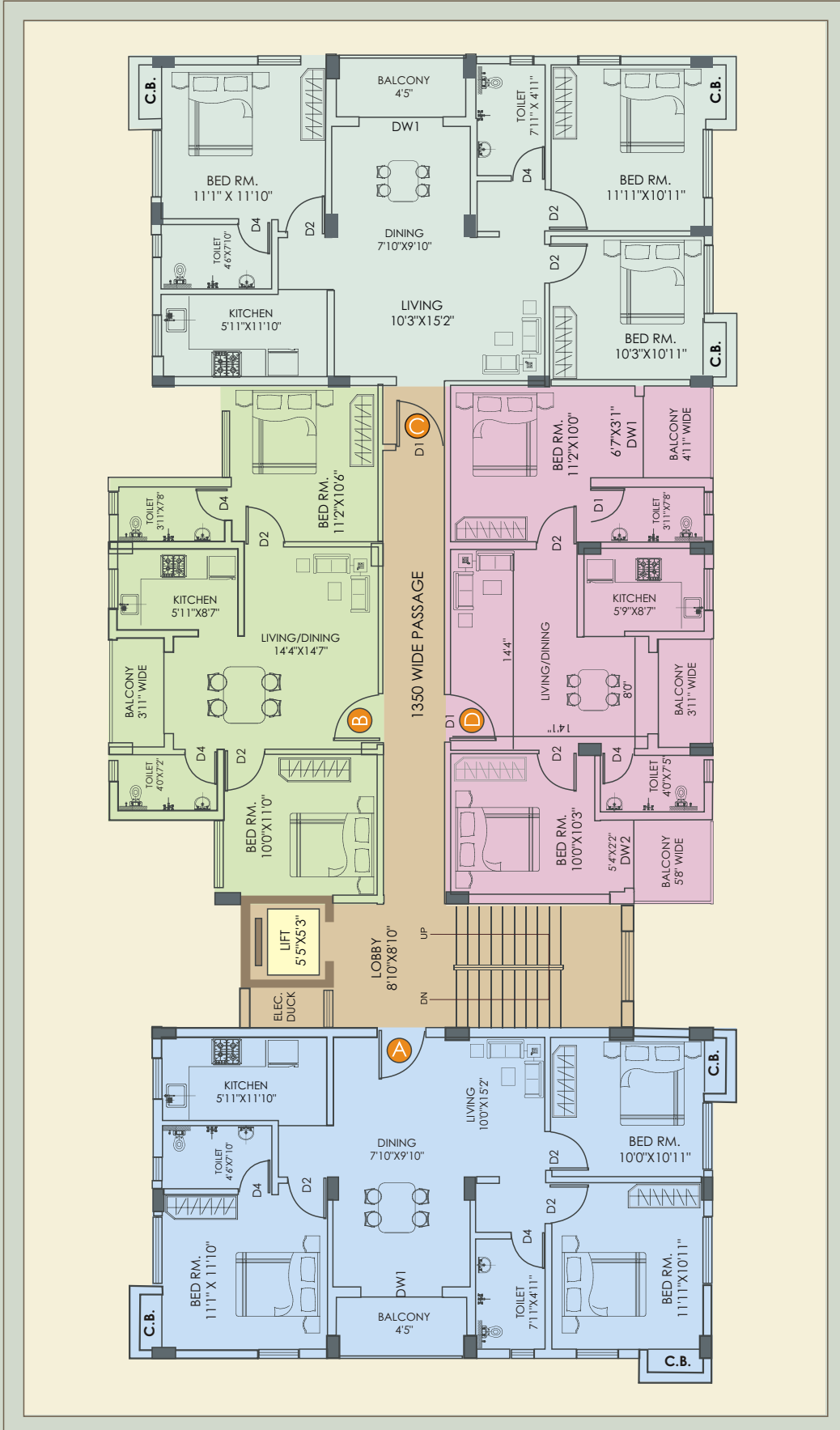

PROPOSED AREA STATEMENT

FLAT TYPE	UNIT TYPE	WBRERA AREA	BALCONY AREA	COVERED AREA	AREA OF PROPORTIONATE AS PER PLAN	BUILT-UP AREA	CHARGEABLE AREA
A	3 BHK + 2 TOI	862	41	972	134	1106	1327
B	2 BHK + 2 TOI	536	30	630	89	719	863
C	3 BHK + 2 TOI	888	41	986	136	1122	1346
D	2 BHK + 2 TOI	551	66	710	100	810	972

DREAM IT . . .

A home where tradition meets modern
Amenities !



FEEL IT . . .

Exclusive Balconys



Get yourself rejuvenated from our
Exclusive Balconies





The JOY OF
EXPLORING

LIVE IT . . .

Spacious 2 BHK / 3 BHK Apartments



Amenities

-  Well ventilated, mostly 3 - sides open
-  CCTV Surveillance
-  7 X 24 Hours Security
-  Modern Elevation
-  High Speed Elevator

